

545D6514

545D0514



WiFer



W

Hvert output:

 1000 W^(*)

 1000 W^(*)

250 VA

500 VA

LED 60 W

^(*)Maks. 1150 W for begge udgange tilsammen.

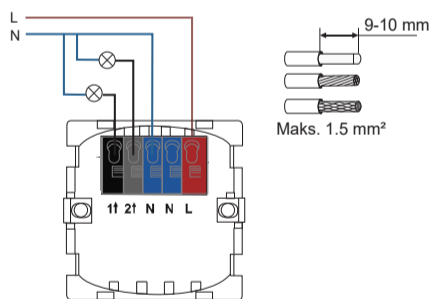
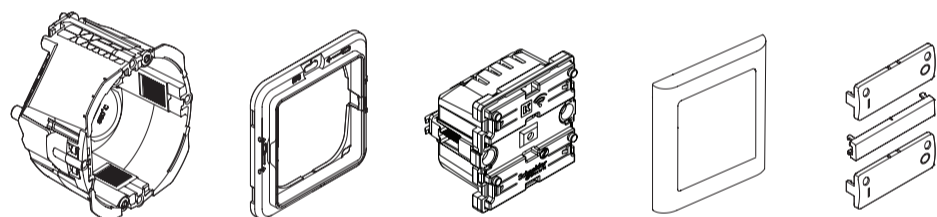
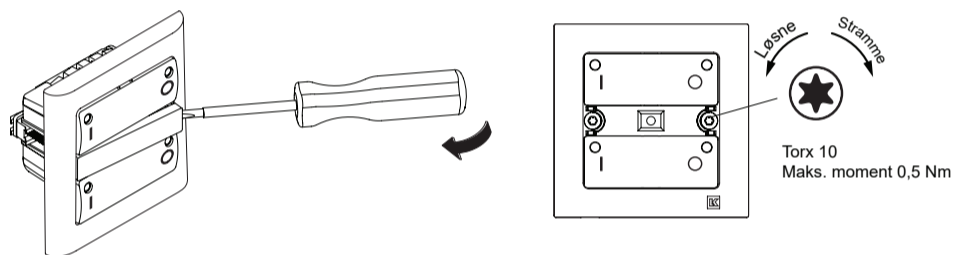
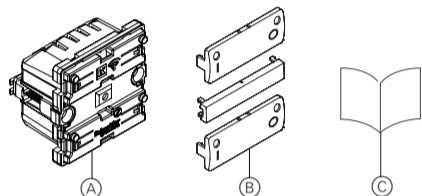

11 18,5

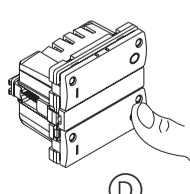
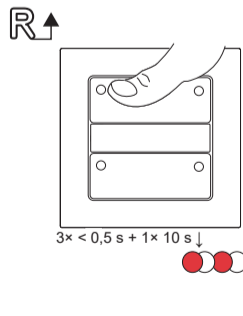
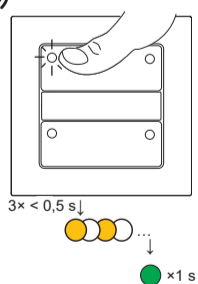
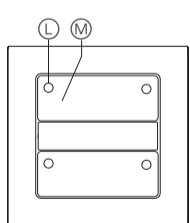

D

Nødvendig tilbehør

En komplet installation kræver

- Designramme og evt. teknisk ramme.
- Tangenter og midterbjælke hvis 545D0514

Forudsætninger

Download **Wiser app'en** til din smartphone / tablet, og installer **Wiser Gateway** for at konfigurere og styre dine Wiser enheder.

Yderligere information

Detaljeret produktinformation er tilgængelig online i **systemvejledningen**: Scan QR-koden eller følg linket.

<https://www1.lk.dk/wiser>

For din sikkerhed

⚠ ⚠ FARE

FARE FOR ELEKTRISK STØD, EKSPLOSION ELLER LYSBUE

Sikker elektrisk installation må kun udføres af kvalificerede fagfolk. Dygtige fagfolk skal have dybtgående viden på følgende områder:

- Tilslutning til fast installation
- Tilslutning af flere elektriske enheder
- Lægning af elektriske kabler
- Sikkerhedsstandarder, lokale regler og forskrifter

Manglende overholdelse af disse instruktioner kan resultere i død eller alvorlig personskade.

⚠ ⚠ FARE

RISIKO FOR FATAL SKADE FRA ELEKTRISK STØD

Udgangen kan have elektrisk strøm, selv når belastningen er slukket.

- Frakobl enheden fra forsyningen ved hjælp af sikringen i det indkommende kredsløb, før du arbejder på enheden.

Manglende overholdelse af disse instruktioner kan resultere i død eller alvorlig personskade.

Lær produktet at kende

LK FUGA® Wiser trådløs dobbelt relæ (i det følgende kaldet **enheden**) er et betjeningsstryk med 2 relæudgange. Betjeningsstryket styrer de tilknyttede relæer, og relæerne kan styres fra andre Wiser enheder.

Enheden kan styres og konfigureres via Wiser app'en (kræver Gateway), eller parres med andre Wiser enheder og indgår i en rumstyring.

For mere information om konfiguration, se system brugervejledning.

Styringsmuligheder

Boligstyring: For at styre enheden via Wiser app skal du bruge Wiser Gateway.

Rumstyring: For at styre enheden med andre Wiser enheder, kan det parres med andre Wiser enheder inden for det samme Zigbee-netværk.

Direkte betjening: Enheden kan altid styres direkte på enheden.

Funktioner

Via app:

- Indstilling af en timer eller en tidsplan
- Indstilling af knappernes lysdiode.

Indhold i pakken

- (A) LK FUGA® Wiser trådløs dobbelt relæ
- (B) Tangenter og midterbjælke (ikke inkluderet for 545D0514).
- (C) Installationsvejledning

Moneringsmuligheder

Enheden skal monteres i en LK FUGA® installationsdåse eller et LK FUGA® underlag. Enheden fylder 1 modul.

Montering af enheden

⚠ FORSIGTIG

- Brug altid produktet i overensstemmelse med de specificerede tekniske data.

Manglende overholdelse af disse instruktioner kan resultere i beskadigelse af produktet.

Forbindelse af enheden

Betjeningslementer

- (L) Status lysdiode
- (M) Setup / reset knap (knappen under midterbjælken har samme funktion).

Indstilling af enheden

Opretter forbindelse til Wiser Gateway

Tryk kort (<0,5 s) på setup / reset knappen 3 gange for at oprette forbindelse til et tilgængeligt Zigbee-netværk. Status lysdioden blinker gult og bliver derefter grønt efter en vellykket forbindelse til Zigbee-netværket.

For mere information se systemvejledningen.

Parring til andre Wiser enheder

For at benytte enheden i rumstyringstilstand kan den parres med andre Wiser enheder inden for det samme Zigbee-netværk.

Nulstilling af enheden

Kort tryk (<0,5 s) på setup / reset knappen 3 gange, og derefter langt tryk (>10 s) på setup / reset knappen én gang for at nulstille enheden til fabrikketilstand.

Status-LED blinker rødt og lyser derefter kontinuerligt, når enheden er nulstillet.

Enheden kan også nulstilles via Wiser app.



Når enheden er nulstillet, slettes alle programmerings- og netværksdata.

Betjening

Ⓧ Tænd og slukker for den tilsluttede belastning.

Du kan fjernstyre enheden med Wiser app (kræver Wiser Gateway).

Betydning af status lysdioden

Se systemvejledning.

Fejlfinding

Se systemvejledning.

Teknisk data

Mærkespænding	230 V a.c. 50 Hz
Mærkestrøm pr. relæ	2x 5 A 140 µF 2x 5 A cos phi = 0,6
Maks. belastning	W
Standby	Maks. 0,4 W
Forsikring	13 A
Overbelastningsbeskyttelse	kortslutning
Udgange	2
Betjening	Lokalbetjening: 2 tangenter med hver 2 knapper, tænd (venstre) / sluk (højre)
Lokal status indikering	4 lysdioder
Timer (tidsforsinkelse)	1 sekund til 24 timer
Forbindelse	230 V, 0 V, Output
Terminaler	Skrueløse terminaler 2x1,5 mm ² (N) 1x1,5 mm ² (L) 1x1,5 mm ² (belastning) Ledning: 1,5 mm ² stiv, flettrådet eller mangetrådet. En leder per hul.
Driftstemperatur	-5 til +40 °C
Fugtighed	10% - 95% relativ, ikke-kondenserende
Modul størrelse	1M
Kapslingsklasse	IP20
Mekanisk beskyttelsesklasse	IK04
Frekvensområde	2,4 GHz
Maks. radiofrekvenseffekt transmitteret	<10 mW
Miljøoplysning	Reach, RoHS, WEEE, Green Premium
EU deklaration	WD20061101
Certifikater, normer	DEMKO, CE, Zigbee 3.0

Bortskaf enheden separat fra husholdningsaffald på et officielt opsamlingssted. Professionel genanvendelse beskytter mennesker og miljøet mod potentielle negative effekter.

Trademarks

- Zigbee® er et registreret varemærke tilhørende Zigbee Alliance.
- Apple® og App Store® er mærkenavne eller registrerede varemærker tilhørende Apple Inc.
- Google Play™ Store og Android™ er mærkenavne eller registrerede varemærker tilhørende Google Inc.

Andre mærker og registrerede varemærker tilhører deres relevante ejere.

EU-overensstemmelseserklæring

Schneider Electric Danmark A/S erklærer hermed, at dette produkt er i overensstemmelse med de væsentlige krav og andre relevante bestemmelser i RADIO EQUIPMENT DIRECTIVE 2014/53 / EU. Overensstemmelseserklæringen kan downloades på adressen se.com/docs.

Lauritz Knudsen

Schneider Electric Danmark A/S, Lautrupvang 1, 2750 Ballerup, Telefon: +45 88 30 20 00, www.lk.dk

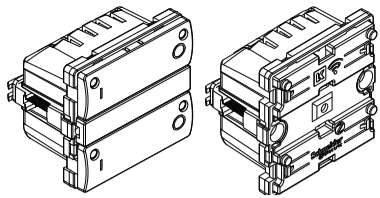

545D6514

545D0514



Wiser



...W

Each output:

- 1000 W ^(*)
- 1000 W ^(*)
- 250 VA
- 500 VA



(*) Max. 1150 W for both outputs combined.

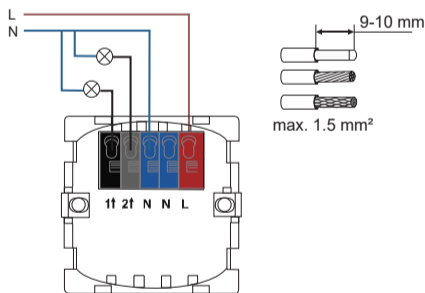
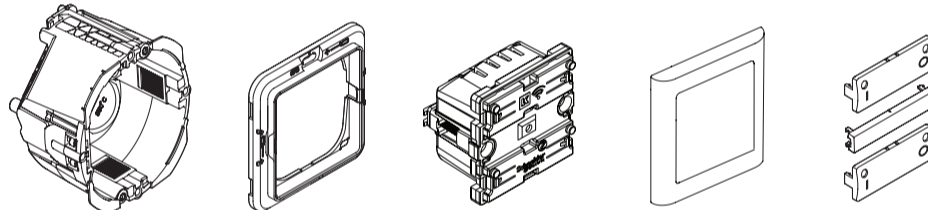
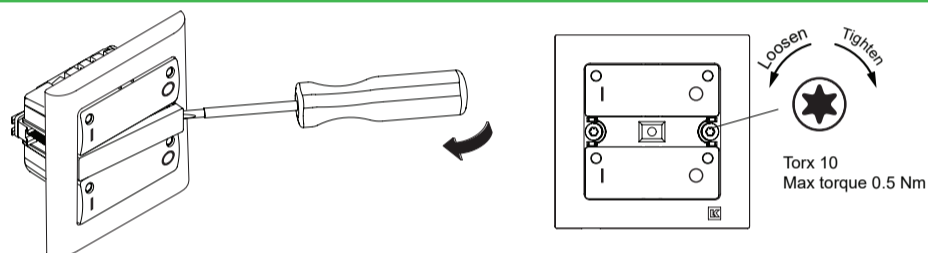
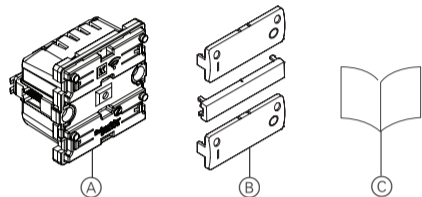

11 18.5

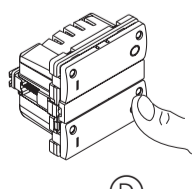
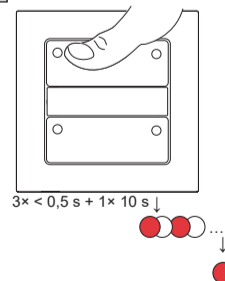
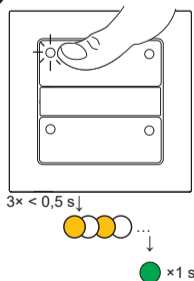
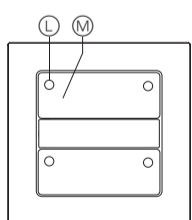

D

Necessary accessories

A complete installation requires

- Design frame and possibly a technical frame.
- Rockers and center cover if 545D0514.

Prerequisites

Download the **Wiser app** to your smartphone/tablet and install the **Wiser Gateway** to configure and control Wiser devices.

Additional system information

Detailed product information is available online in the **system user guide**: Scan the QR code or follow the link.

<https://www1.lk.dk/wiser>**For your safety****⚠ ⚠ DANGER****HAZARD OF ELECTRIC SHOCK, EXPLOSION, OR ARC FLASH**

Safe electrical installation must be carried out only by skilled professionals. Skilled professionals must prove profound knowledge in the following areas:

- Connecting to installation networks
- Connecting several electrical devices
- Laying electric cables
- Safety standards, local wiring rules and regulations

Failure to follow these instructions will result in death or serious injury.

⚠ ⚠ DANGER**RISK OF FATAL INJURY FROM ELECTRIC SHOCK**

The output may carry electrical current even when the load is switched off.

- Disconnect the device from the supply by means of the fuse in the incoming circuit before working on the device.

Failure to follow these instructions will result in death or serious injury.

Getting to know the product

The LK FUGA® Wiser wireless double relay (hereafter referred to as the **device**) is a switch panel with 4 push buttons and 2 relay outputs. The push buttons can control the associated relays, and the relays can be controlled from other Wiser devices.

The device can be controlled and configure via the Wiser app (requires a Gateway), or paired with other Wiser devices to form a room control.

For more information on configuration, see the system's user guide.

Control options

Home control: To control the device through the Wiser app you will need the Wiser Gateway.

Room control: To control the device with other Wiser devices, it can be paired with other Wiser devices within the same Zigbee network.

Direct operation: The device can always be controlled directly on-site.

Functions**Via app:**

- Setting a timer or a time schedule
- Setting the buttons LED.

Contents of the box

- (A) LK FUGA® Wiser wireless double relay.
- (B) Rockers and center cover (not included for 545D0514).
- (C) Installation guide.

Mounting options

The device must be mounted in LK FUGA® installation boxes or LK FUGA® surface installation boxes. The device size is 1 module.

Mounting the device**⚠ CAUTION**

- Always operate the product in compliance with the specified technical data.

Failure to follow these instruction can result in equipment damage.

Connecting the device**Operating elements**

- (L) Status LED
- (M) Setup / reset button (the button under the center cover has the same function).

Settings**Connecting to the Wiser Gateway**

Short press (< 0,5 s) the Setup/Reset button 3 times to connect to an available Zigbee network. The status LED blinks amber and then turns green upon successful connection to the Zigbee network.

For more information refer to the system user guide.

Pairing to other Wiser devices

To control products in a room control mode, it can be paired with other Wiser devices within the same Zigbee network.

Resetting the device

Short press (< 0,5 s) the Setup/Reset button 3 times and then long press (>10 s) the Setup/Reset button once to reset the device to factory default mode.

The status LED blinks red and then turns red upon successful reset of the device.

The device can also be reset via the Wiser app.



After the device is reset all the programming and network data will be deleted.

Operating

- (D) Switch the load on and off.

You can remotely control the unit via the Wiser app (requires Wiser Gateway).

Behaviour of the status LED

Refer to the system user guide.

Troubleshooting

Refer to the system user guide.

Technical data

Rated Operational Voltage	230 V AC 50 Hz
Rated Current per relay	2x 5 A 140 µF 2x 5 A cos phi = 0.6
Nominal power	
Standby Consumption	Max. 0.4 W
Associated Fuse Rating	13 A
Protection Type	Short-circuit Protection
Number of Outputs	2
Control Type	Local control: 2 rockers with 2 push buttons each, ON (left) / OFF (right)
Local Signaling	4 LED
Time Delay Range	1 Second to 24 Hour
Connection	Line, Neutral, Load
Terminals	Screwless terminals 2x1.5mm ² (N) 1x1.5mm ² (L) 1x1.5mm ² (Load) Wire: 1.5mm ² solid, stranded or multi-stranded. One wire per hole.
Operating Temperature	-5 to +40°C
Operating Humidity	10% - 95% RH, Non-condensing
Module size	1M
IP Degree of Protection	IP20
IK Degree of Protection	IK04
Operating frequency	2.4 GHz
Max. radio-frequency power transmitted	<10 mW
Environmental Disclosure	Reach, RoHS, WEEE, Green Premium
EU declaration	WD20061101
Product Certifications	DEMKO, CE, Zigbee 3.0



Dispose of the device separately from household waste at official collection point. Professional recycling protects people and the environment against potential negative effects.

Trademarks

- Zigbee® is a registered trademark of the Zigbee Alliance.
- Apple® and App Store® are brand names or registered trademarks of Apple Inc.
- Google Play™ Store and Android™ are brand names or registered trademarks of Google Inc.

Other brands and registered trademarks are properties of their relevant owners.

EU Declaration of conformity

Hereby, Schneider Electric Danmark A/S, declares that this product is in compliance with the essential requirements and other relevant provisions of RADIO EQUIPMENT DIRECTIVE 2014/53/EU. Declaration of conformity can be downloaded on: se.com/docs.

Lauritz Knudsen

Schneider Electric Danmark A/S, Lautrupvang 1, 2750 Ballerup, Phone: +45 88 30 20 00, www.lk.dk